

Preliminary

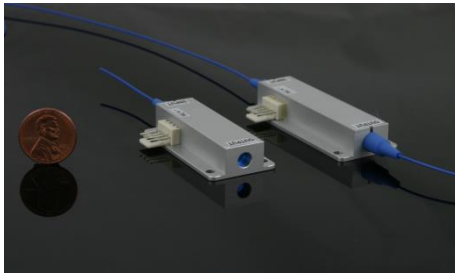

- Plug & play
- Single-pass & high-efficiency via waveguide structure
- Compact & robust

Reference Specification sheet

Optics (General)	unit	Specification			Note
Mixer Type		Second Harmonic Generation (SHG)			
Mixer Pigtailling Type		1X1			
Input Wavelength	nm	1064			
Output Wavelength	nm	532			
Input Fiber, Connector		PM980, FC/APC			
Output Fiber, Connector		PM480, FC/APC			
Specified pump power	W	0.85			
Pump condition		CW, multimode mode, <0.15nm linewidth			
Optics (output)	unit	Minimum	Typical	Maximum	Note
Output power @ specified pump	W	0.15	0.17		[1]
Output polarization state		linear @ slow axis			
Mechanics	unit	Specification			Note
Housing dimension (L*W*H)	mm	70x25x10.5			
Electrics	unit	Minimum	Typical	Maximum	Note
Electrical connector		Molex 0022112042 (4P)			
Thermoelectric cooler		3.9V, 1.7A maximum, Qc = 4.3 W			
NTC Thermistor resistance@25°C	kΩ	10			
Thermistor B vale (B25/85)	K	3478			
Environment	unit	Minimum	Typical	Maximum	Note
Storage temperature (no humidity)	°C	-20	-	70	
Operating temperature range	°C	10	25	35	
Operating relative humidity (non condensing)	%RH	0	-	85	
Vibration / Shock		Refer to ISTA-2A			
Restriction of hazardous substances directive (RoHs)		Declaration of Conformity to 2011/65/EG			

[1] Input wavelength only filtered by the output fiber, typically >20dB attenuation

- Mechanical drawing

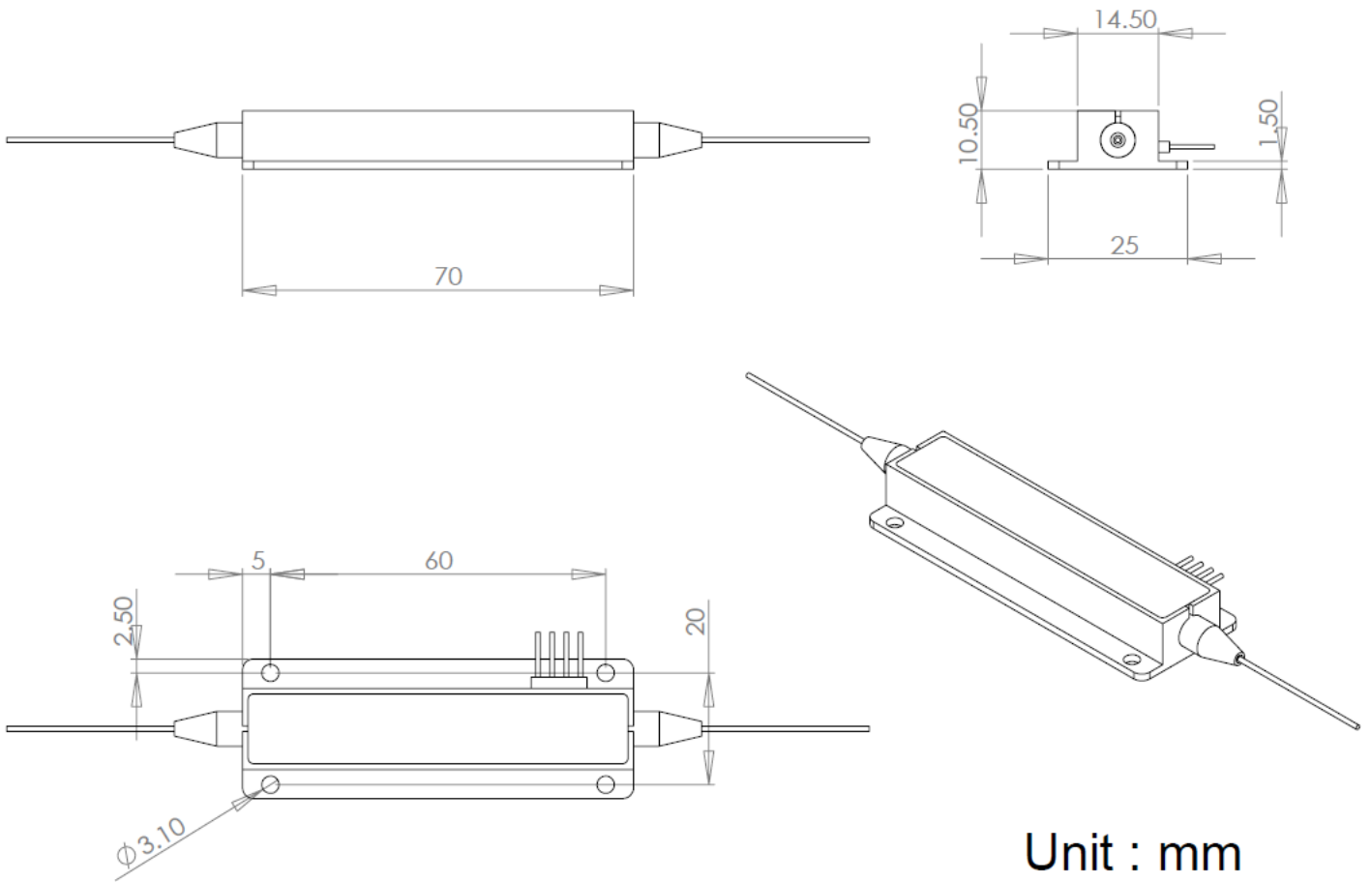

Unit : mm